

Installation

WHAT'S IN THE BOX?

- Flap Valve

TOOLS/MATERIALS YOU MAY REQUIRE

- Silicone (optional)
- Solvent weld glue (optional)

FOR A TANK OVERFLOW OUTLET OR TANK OVERFLOW OUTLET PIPE

1. Select an installation point for your Flap Valve. It can be attached directly to your tank overflow outlet, or to your horizontal tank overflow outlet pipe.
2. Orient your Flap Valve so the hinge is at the top, then secure directly to your chosen installation point with silicone or solvent weld glue.

FOR A NON-PLUMBED TANK INLET PIPE

1. Orient your Flap Valve so the hinge is at the top, then secure directly to your non-plumbed tank inlet pipe with silicone or solvent weld glue.

MAINTENANCE

Your Flap Valve is self-closing and largely self-cleaning, so it requires little to no maintenance. If maintenance is required, simply hose or brush off the flap or mosquito-proof stainless steel vented screen.

PRODUCT DIMENSIONS

TAFV01 50MM

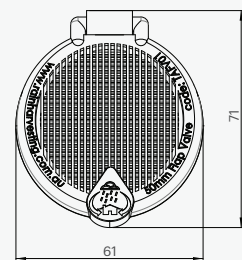

FRONT VIEW

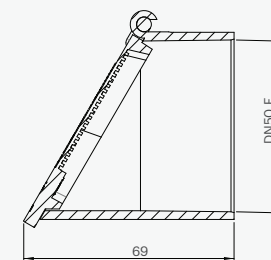

SECTION VIEW

TAFV02 90MM M

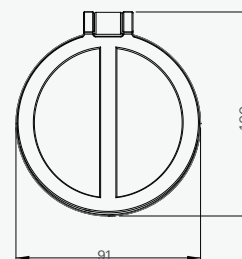

FRONT VIEW

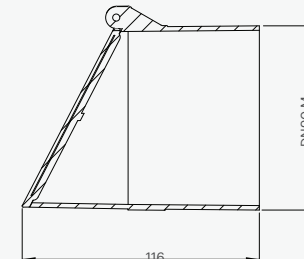

SECTION VIEW

TAFV12 90MM F

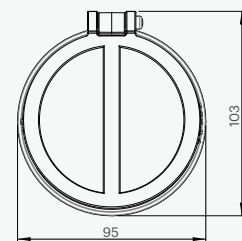

FRONT VIEW

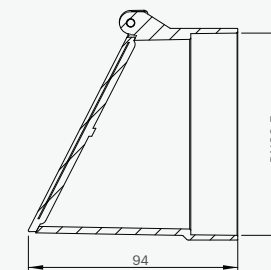

SECTION VIEW

TAFV03 100MM

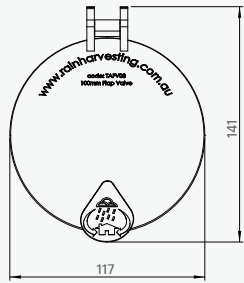

FRONT VIEW

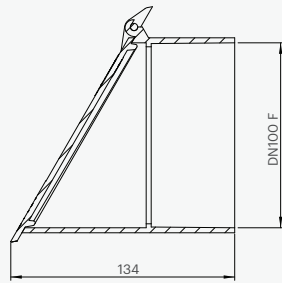

SECTION VIEW

TAFV04 100MM

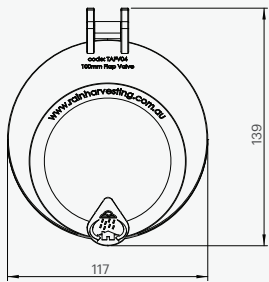

FRONT VIEW

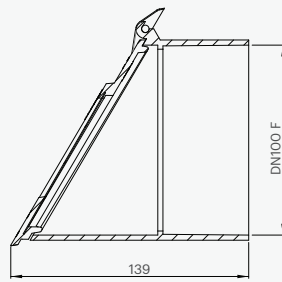

SECTION VIEW

ALL DIMENSIONS IN MM UNLESS OTHERWISE STATED.

Pipe Fitment

TAFV01	DN50 F (socket)	50mm pipe fits inside
TAFV02	DN90 M	Fits into 90mm socket
TAFV12	DN90 F (socket)	90mm pipe fits inside
TAFV03	DN100 F (socket)	100mm pipe fits inside
TAFV04	DN100 F (socket)	100mm pipe fits inside

DISCLAIMER This product specification is not a complete guide to product usage. Product specifications may change without notice. For more information visit rainharvesting.com.au. Keep this manual handy for future reference. © Rain Harvesting Pty Ltd.

COMPLIANCE

- AS/NZS 4020:2005 - Testing of products for use in contact with drinking water

RAIN HARVESTING

by Blue Mountain Co

rainharvesting.com.au

+61 (0)7 3248 9600

RAIN HARVESTING
by Blue Mountain Co

Flap Valve

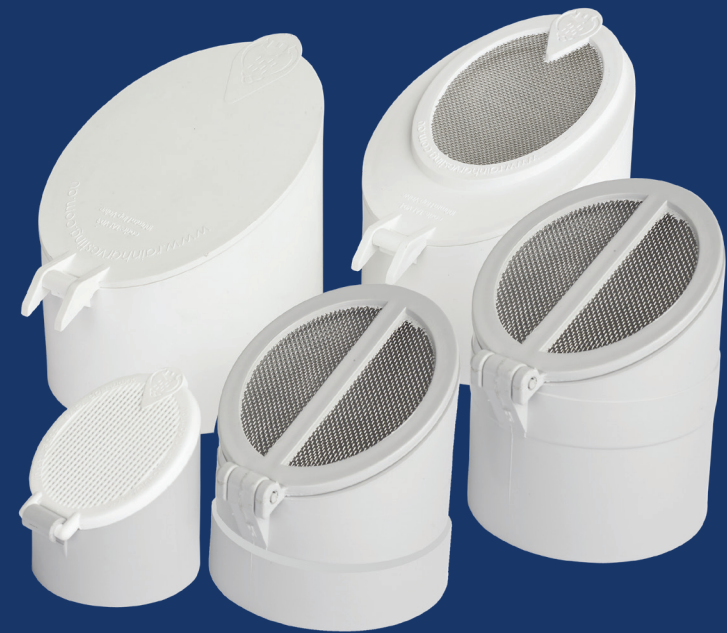

Installation and Specification Guide

PRODUCT DETAILS

Keep mosquitoes, frogs and pests out of your tank inlet and outlet pipes without restricting water flow.

- TAFV01 50mm - vented plastic
- TAFV02 90mm M - vented stainless steel
- TAFV12 90mm F - vented stainless steel
- TAFV03 100mm - plain plastic
- TAFV04 100mm - vented stainless steel

FEATURES AND BENEFITS

- Keep mosquitoes, frogs and pests out of your tank inlet and outlet pipes and your Rain Harvesting system
- Self closing flap can open fully during high flow events so water flow is not impeded.
- Improve ventilation and oxygen circulation in your rainwater tank (vented models)
- Made from UV-stabilised UPVC for longevity